



### 11 Marshall Terrace BROOKLYN PARK SA

5  3  3 

This property represents a wonderful family home offering plenty of space inside and out.

Located close proximity to quality public and private schools, local shopping, medical facilities/Hospital, public transport, 10 minutes to the City and only 10 minutes to the beach.

This rendered/brick Art Deco home was built C1940's on a huge allotment of approximately 1045m<sup>2</sup>. The home offers a massive floor plan of 5 bedrooms with plenty of built-ins, master/guest room is located towards the rear with adjacent bathroom, powder room and wc. The extra wide entry hallway leads through to the huge open plan living area with vaulted ceilings, doors with leadlight inserts, solid built kitchen with plenty of cupboard/bench space, gas cooker, pantry and dishwasher. The adjacent dine and

**View :** <https://www.michaelkris.com.au/sale/sa/western-beachside-suburbs/brooklyn-park/residential/house/5834353>



**Kris Papagiannis**  
08 8353 3000

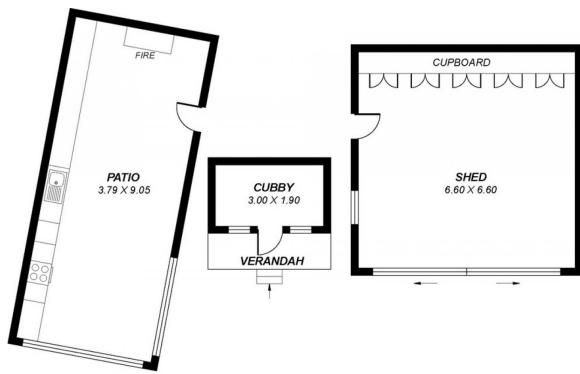

This drawing is for illustration purposes only.  
All measurements are approximate and details intended  
to be relied upon should be independently verified.

Area	m <sup>2</sup>
Living	301.15
Porch	12.39
Patio	81.98
Carport	72.19
Verandah	40.12
Shed	51.49
Cubby	7.14
<b>Total</b>	<b>566.46</b>