

9/49 Glen Rowan WOODVILLE SOUTH SA

3  2  2 

This executive townhouse is built to suit those looking for a low maintenance lifestyle in a prime location. Located just a few minutes walk to the Queen Elizabeth Hospital, excellent transport links to the CBD and close proximity to West Lakes & Port Adelaide shopping precincts.

View : <https://www.michaelkris.com.au/lease/sa/western-beachside-suburbs/woodville-south/residential/townhouse/6546518>

It also offers all the modern conveniences that you would expect:

- Large ground floor open plan living and dining
- Large second upstairs living or kids retreat or study
- 3 Large bedrooms all with built ins
- Master bedroom with walk-in robes and ensuite
- Modern timber look kitchen with stainless steel euro appliances including dishwasher
- Fully zoned ducted reverse cycle air conditioning upstairs and downstairs



Claudia Rundell
0883533000

Floor Plans—Houses 8-10

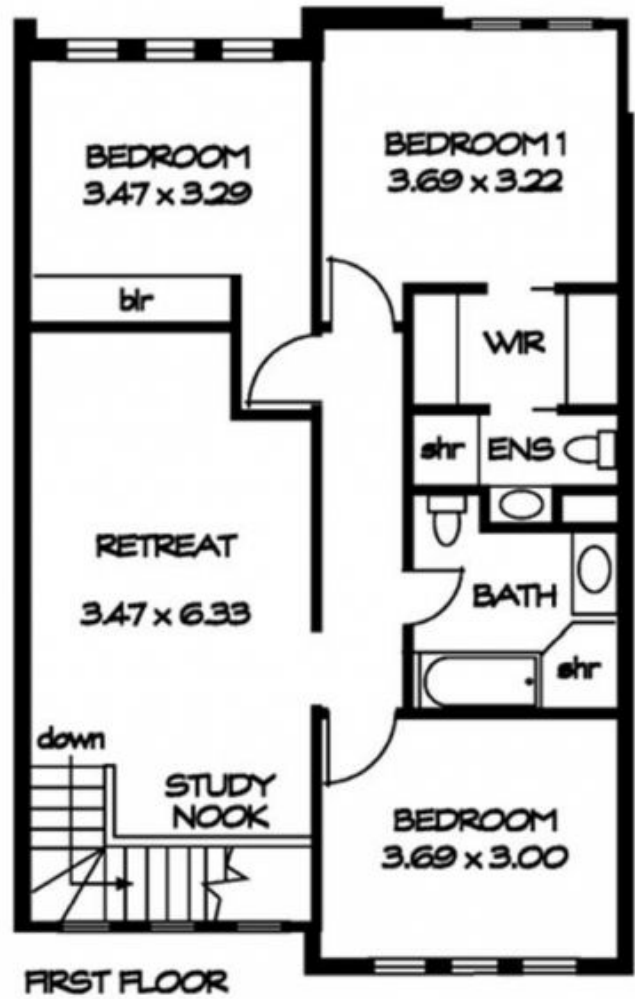
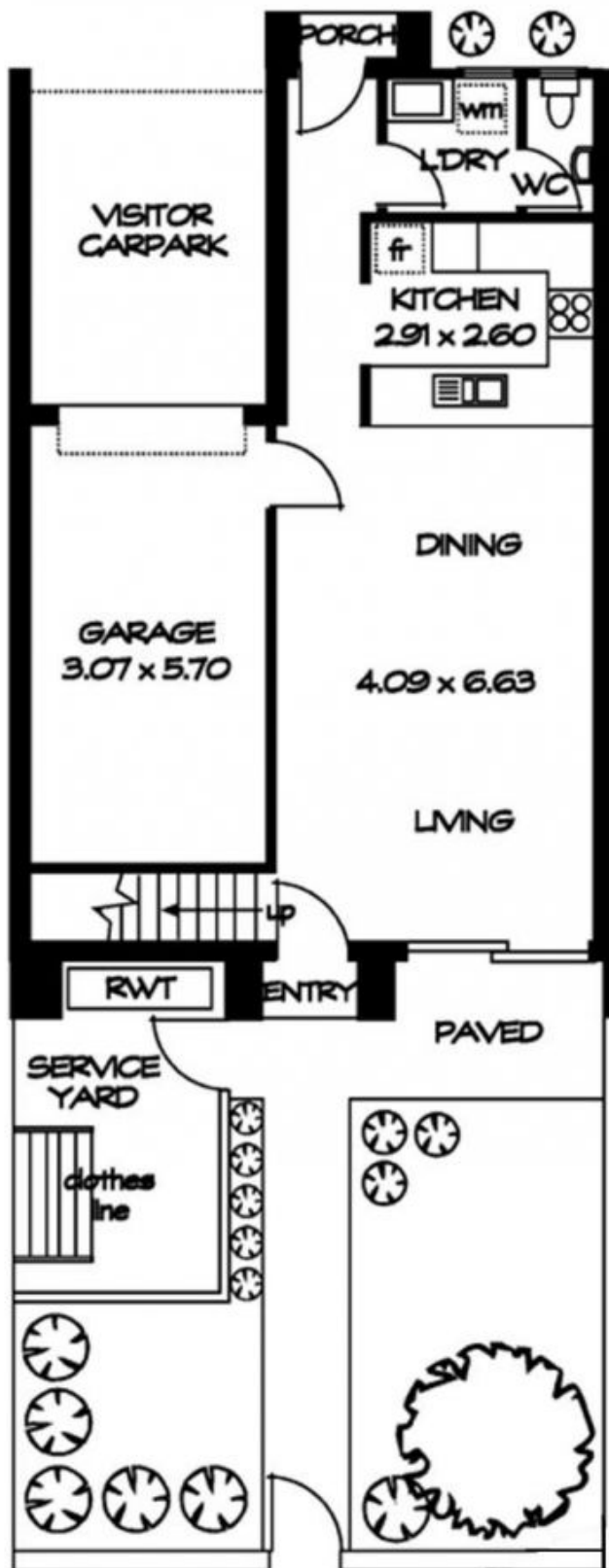

TOWNHOUSES 8, 9 & 10
AREAS (approx) m²

GROUND:	54.30
FIRST:	86.44
GARAGE:	18.82
PORCH:	1.22
ENTRY:	1.62
TOTAL	162.40