

16 Calthorpe Terrace OTTOWAY SA

3  1  2 

The suburb of Ottoway is a hidden GEM; minutes from the thriving Port Adelaide precinct, due to the State Government's vision for the future. Enjoy some of Adelaide's pristine beaches, Port Canal Shopping Centre, upmarket restaurants and cafes, fresh food markets, laneway festivals, Port dock and Dolphin Cruises makes this a must see location. The quality private and public schools, many parks and playgrounds are also a great attraction to want to call Ottoway home. The Adelaide CBD is only approximately 14kms away by car or public transport.

This gorgeous C1950's solid brick home is one to be seen; with its unique design. charm and characteristics, it will be love at first sight. The home is set on a substantial allotment of approximately 474m2 and set amongst homes of similar era and character, making Ottoway a standout

Land Size : 474 sqm

View : <https://www.michaelkris.com.au/sale/sa/western-beachside-suburbs/ottoway/residential/house/7451758>



Michael Georgiadis
08 8353 3000

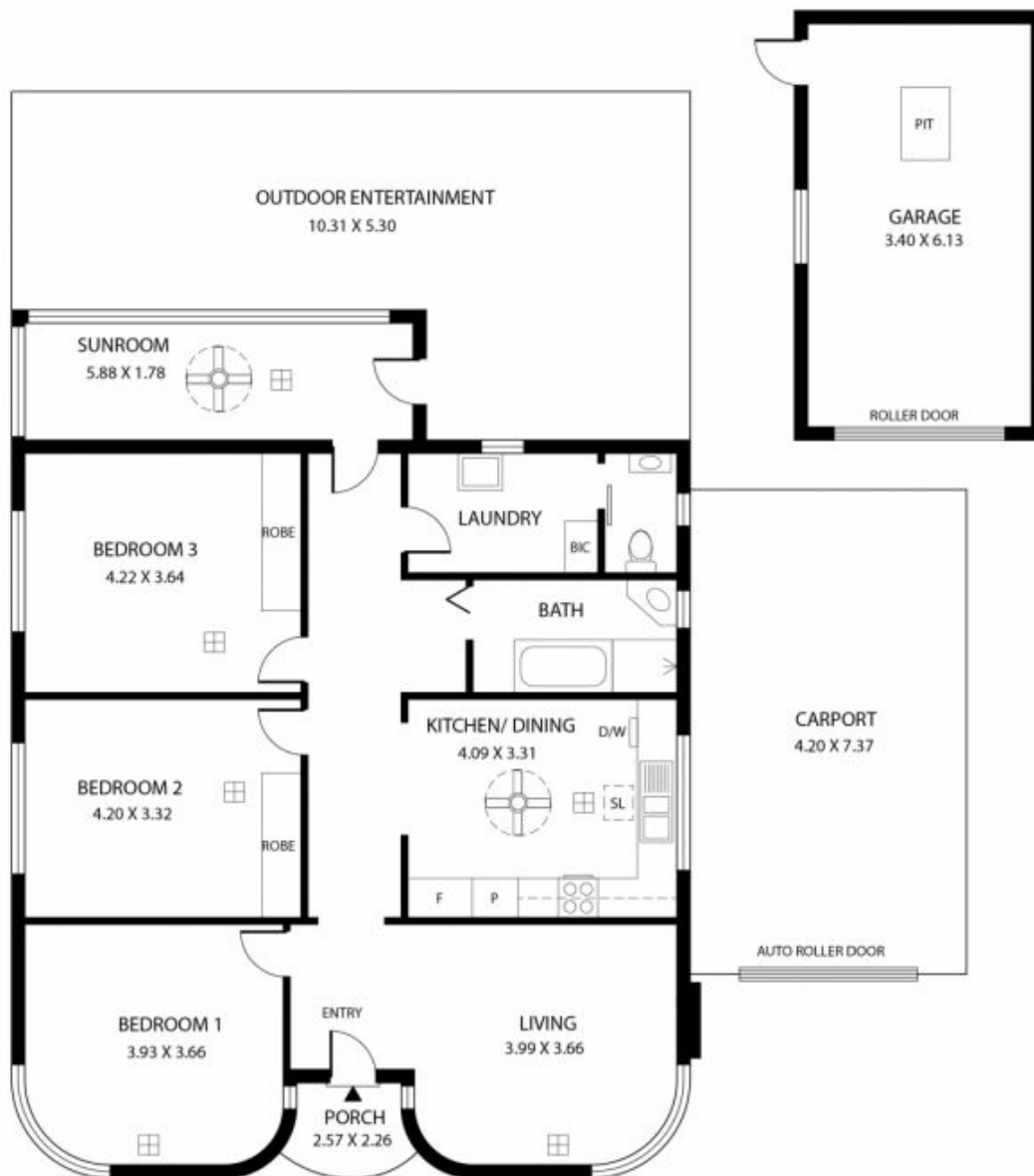

224m²

TOTAL

124m²

Living

31m²

Carport

25m²

Garage

2m²

Porch

42m²

Outdoor
Entertainment



16 CALTHORPE TERRACE, OTTOWAY

Scale in metres. This drawing is for illustration purposes only. All measurements are approximate and details intended to be relied upon should be independently verified.

Produced by The Fotobase Group